

Product

CS-2 Condensate Safety Overflow Switch (Pipe Mounted)

Plenum Rated

Purpose

DiversiTech Flood Prevention Switches are simple to install, easy to service, and extremely reliable. As water level in the auxiliary or main drainpipe rises due to a clogged air conditioning condensate drain, the switch shuts off the system, thus preventing water from over-flowing and causing damage to doors, walls, and ceilings.

Features

- Small size for serviceability
- Has a pull-to-test lever for verifying correct installation
- Constructed of materials that will not rust or stick
- Switch operates smoothly every time
- Integrated LED light indicator notifies homeowners and technicians activation has occurred
- Internal surge protector eliminating the risk of inadvertent shutdowns
- Comes with 6 feet of wire for easy installation
- Plenum rated

General Specifications

- Voltage: 24 volts
- Amperage: 1.5 amps
- Operates via a reed switch
- ETL Listed
- Conforms to UL 508 and UL 2043

General Characteristics

Part Number	Type	Switch Type	Order Multiple
CS-2	Tee	Magnetic Reed	10
CS-2-BULK50	Tee	Magnetic Reed	50

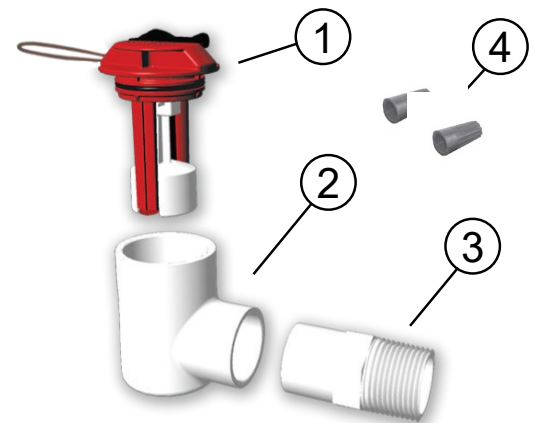

- | | |
|---|-----------------------|
| ① | Sensor Assembly |
| ② | Pipe Elbow |
| ③ | 3/4" Threaded Fitting |
| ④ | Wire Nuts |

